

Horizontal Mill (GMH)

Precision-Meets-Versatility: Leak-Proof Milling Solution

The Horizontal Mill (GMH-series), constructed from high-grade steel, incorporates a mechanical seal type to ensure leak-free operation under various conditions. It guarantees consistent, efficient processing, longevity, and minimal downtime.

This versatile machine effortlessly handles high and low viscosity mill bases, streamlining efficiency in one-tank operations. Its energy-optimized design reduces consumption, ensuring cost-effective performance. Its horizontal orientation, allows for easy operation and minimal maintenance.

The ability to use harder media increases its flexibility. The Horizontal Mill represents a dependable and efficient milling solution.

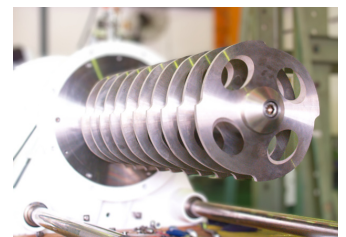

Efficient Processing

Effectively grinds high-viscosity concentrates



Mechanical Seal

Ensures leak-proof operation and extended equipment life.

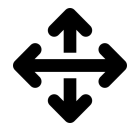

Versatile & Efficient

Handles High and Low Viscosity Mill Bases



Hygienic Design

Stainless Steel Tank & Pocketless Valve for Easy Cleaning.



Durable

Built for longevity and minimal downtime. High quality steel



Energy-Optimized

Low energy consumption for cost-effective operation



SCADA + HMI Control & Monitoring Option



Hygienic Design Option



Hazardous Environment Option

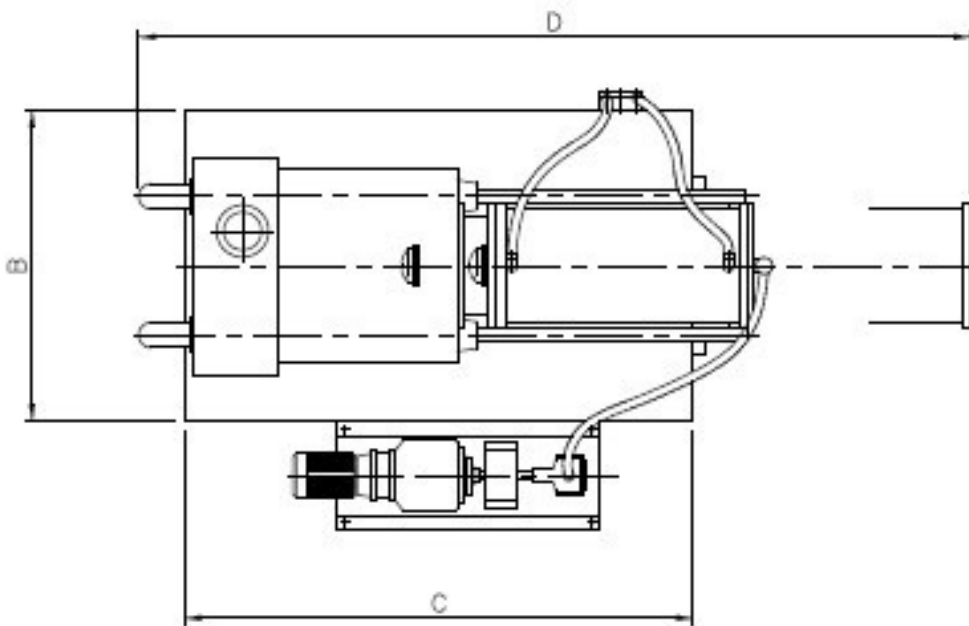
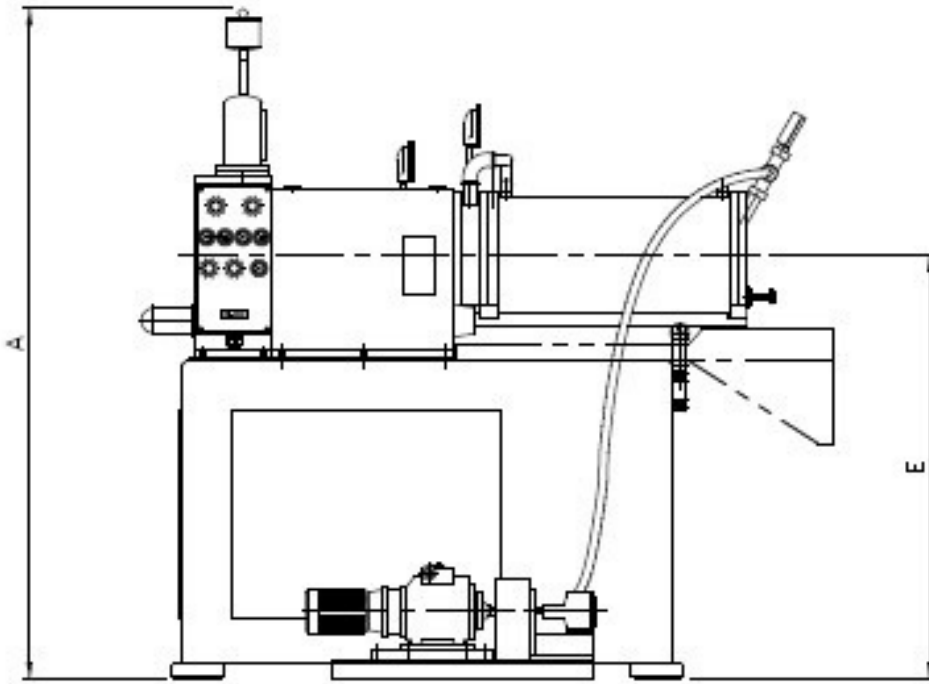

Model	Vessel Capacity (ℓ)	Motor (KW)		Peripheral Speed m / sec	Weight (kg)	A	B	C	D	E
		Main	Pump							
GMH-L	1	1.5	0.2	8 • 10 • 12 • 15	60	725	350	500	600	360
GMH-G2MR	2	3.7	0.2	8 • 10 • 12	80	835	400	530	800	430
GMH-G5MR	5	7.5	0.75	10 • 12	700	1473	600	900	1412	880
GMH-G20MR	20	15 • 20	0.75 • 1.5	10 • 12	1200	1595	790	1190	1748	990
GMH-G50MR	50	30 • 37	1.5	10 • 12	1500	1950	940	1500	2501	1225
GMH-G100MR	100	37 • 45	2.2	10 • 12	2500	2050	1100	1950	3820	1400



Cyclelect Nismix Pte. Ltd.

515 Yishun Industrial Park A, Singapore 768737
 T: +65 6868 6000 • E: hello@nismix.com.sg
 W: nismix.com.sg

70+ years of industrial powder and liquid mixer solutions, from concept to integration, empowering production plant owners.

